

Brushless DC Circulating Pump (Mechanical Seal)

Feature :

- * Low temperature rise and durability.
- * Tenfold life time to AC brush motors.
- * Variable speed available and low noise.
- * High level of efficiency and energy-saving.
- * Totally design and manufacture in Taiwan.
- * Without carbon pollution, environmentally friendly and free maintenance.

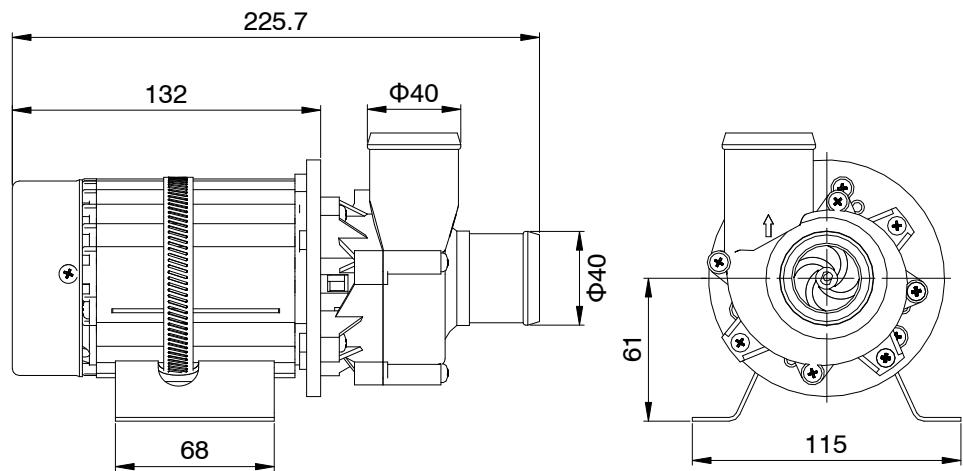

Motor protection :

- * Reverse polarity, Soft start protection, Over-load protection, Locked-rotor protection, Over temperature protection, Over voltage protection, Lower voltage protection.

Model	Voltage (Vdc)	Voltage Range	Current (A)	Output	Note
P047D024-001S	24	16-32V	3.5	against 0.2bar 5300ℓ/hr.	5000S
P047D024-002S	24	16-32V	7.1	against 0.4bar 6000ℓ/hr.	6000S
P047D012-006S	12	9-14V	8.9	against 0.2bar 6400ℓ/hr.	5000S+ -12V
P047D012-008S	12	9-14V	6.7	against 0.2bar 5000ℓ/hr.	5000S-12V
P047D024-012S	24	16-32V	10.5	against 0.4bar 7000ℓ/hr.	6000S+

POWER CIRCLING CO., LTD. 速克立股份有限公司

No. 991 Zhongshan Rd. Shengang Dist. Taichung 42955, Taiwan

TEL : +886-4-2561-4924

FAX : +886-42561-6479

E-mail : pc.motor@msa.hinet.net

Website : www.powercircling.com



Performance

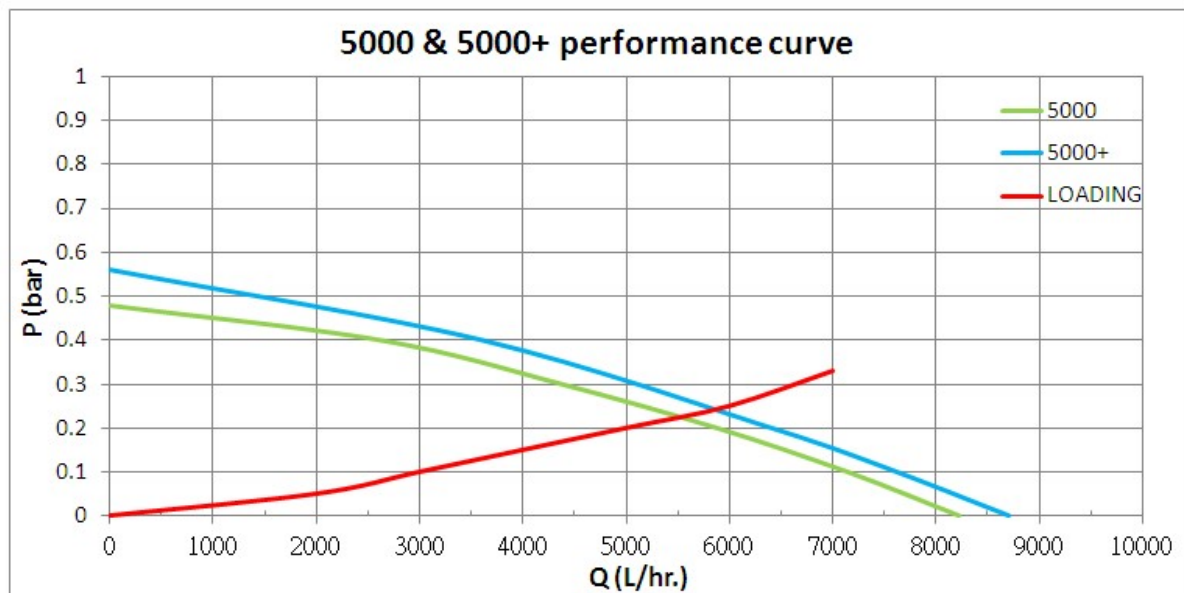
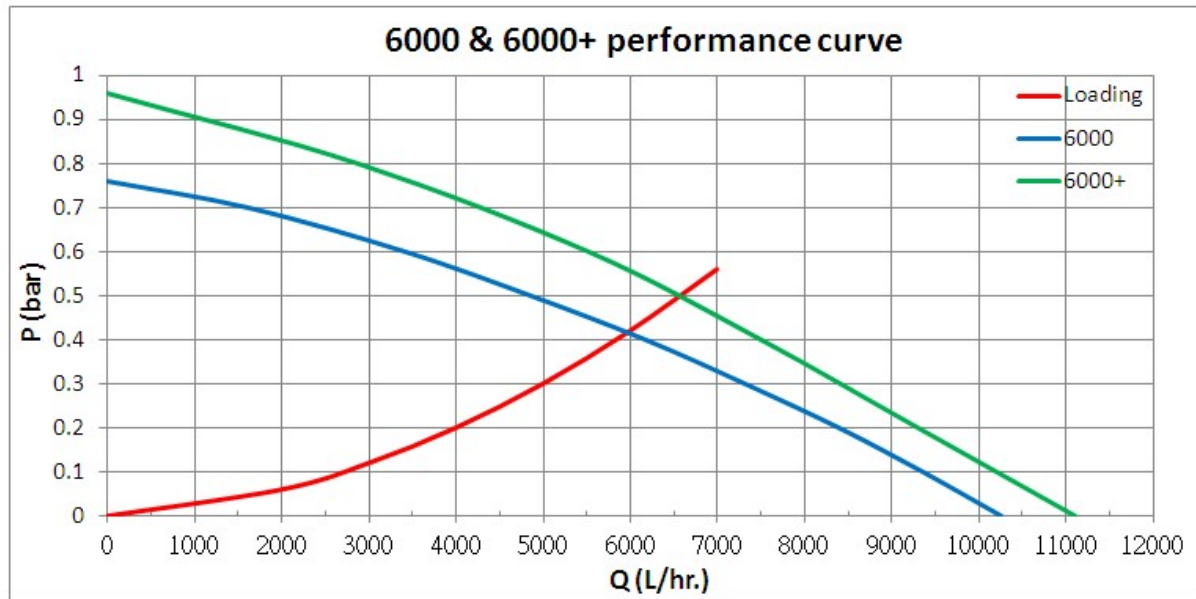

Motor Protection :

- ◆ Reverse polarity: out of action when positive and negative pole is reversed.
- ◆ Soft start protection: slowly starting and speeding.
- ◆ Over load protection: out of action when current is over 16A, starting afresh while load lower than 16A
- ◆ Locked-rotor protection: out of action when rotor is locked, starting afresh after block is cleared.
- ◆ DC24V over voltage & lower voltage protection: 16~32V
- ◆ DC12V over voltage & lower voltage protection: 9~14V
- ◆ Over temperature protection: out of action when motor temperature is over 85°C, starting afresh while lower than 80°C. (operating temperature range: -30°C ~ 50°C.)
- ◆ IP level: IP54 ~ IP66

DC24V motor wiring

2 WIRES; FULL SPEED

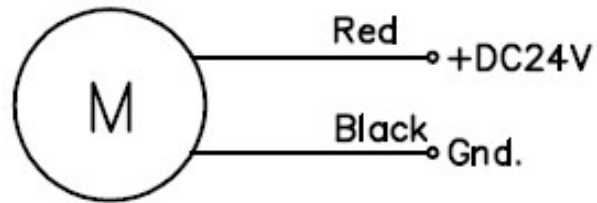

3 WIRES; FULL SPEED

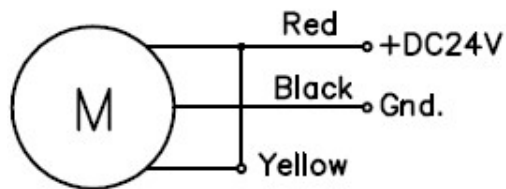

3 WIRES; VARIABLE SPEED

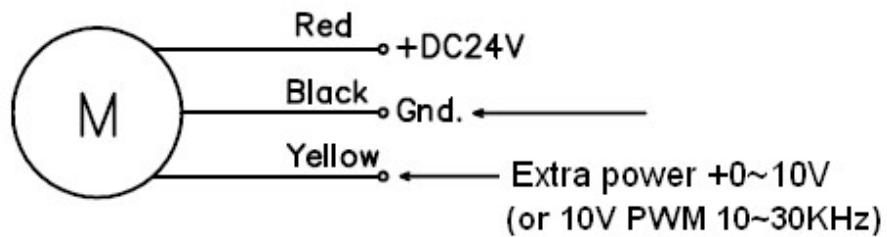

3 WIRES; VARIABLE SPEED

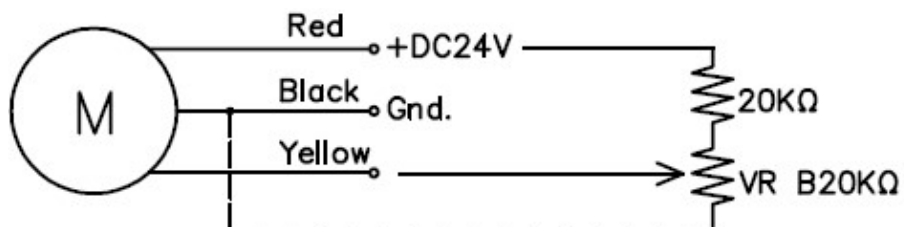

DC12V motor wiring

2 WIRES; FULL SPEED

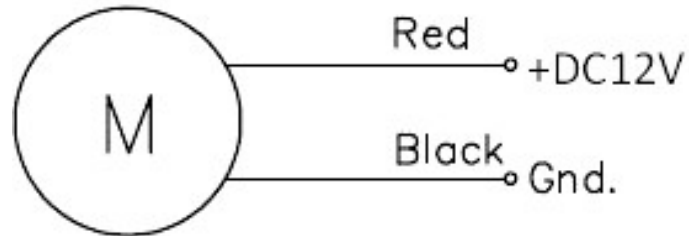

3 WIRES; FULL SPEED

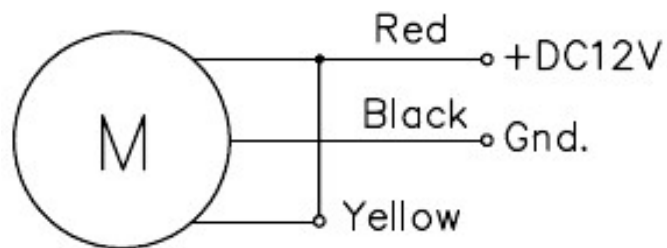

3 WIRES; VARIABLE SPEED

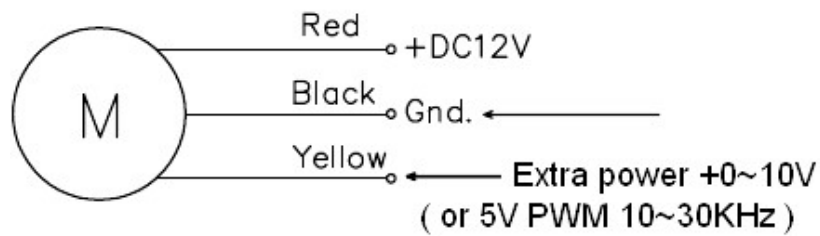

3 WIRES; VARIABLE SPEED

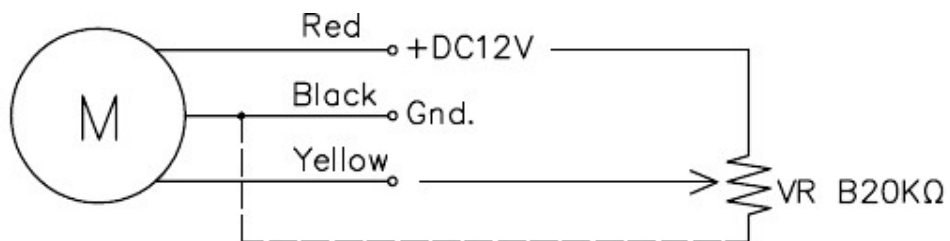

Exploded drawing

13	Frame	1	SPCC/Zinc Electroplating/coating
12	Restrain Ring	1	SUS 304
11	Motor	1	Brushless DC
10	Washer	1	NBR
9	Housing(2)	1	PPS + 40%Fiber
8	O Ring	1	Silicon Rubber
7	Mechanical Seal	1	SIC
6	Impeller	1	PPS + 40%Fiber
5	Screw	4	SUS 304
4	Nut	1	SUS 304
3	Housing(1)	1	PPS + 40%Fiber
2	Screw	4	SUS 304
1	Copper Tube	2	Copper
No	Part Name	Q'ty	Material

